

# LG CLOi ServeBot

The Swift and Reliable Serving Specialist

World's First Service Robot to Achieve UL3300 Certification\*



\*UL 3300: for safe robot operation in complex commercial environments such as restaurants, retail stores and hotels.





# Leave it to **LG CLOi** ServeBot: your serving specialist!

This smart robot solution performs simple and repetitive tasks based on its innovative autonomous driving system. The LG CLOi ServeBot, revamped with advanced technology and next-level convenience, executes serving tasks with excellent performance.

## LG CLOi ServeBot's versatile serving skills

### Accurate Tracking

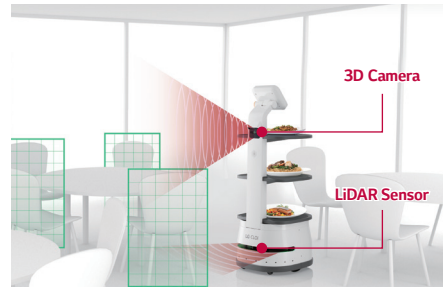

Like the human eye, the 3D camera and LiDAR sensor recognize objects and determine the robot's path, allowing it to freely and accurately navigate, even through (or in) tall, narrow, or complex spaces. Requires advance mapping of table layout for service area.

### Safe Movement



The 3D camera sensor detects low obstacles, while ToF sensors reliably recognize nearby or rapidly approaching objects, allowing ServeBot to avoid even small obstacles as it safely and autonomously navigates the spaces.

### Professional serving

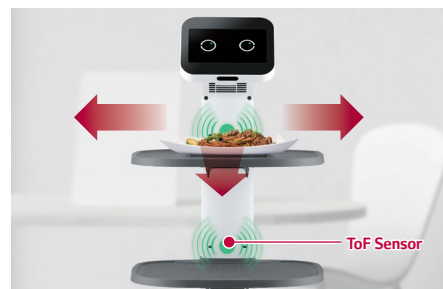

The front, left, and right sides are open to conveniently serve dishes and trays. Each shelf features a ToF sensor that automatically detects food; once removed, the robot automatically proceeds to the next destination, without any additional input required.

### Smart and Convenient



With just a few screen touches, users can easily change the designated location\* and select different modes through an intuitive UI on the 9.2" display. Users can also modify voice\*\* announcements and music played in response to customers. Additionally, the robot's status can be monitored in the cloud to be conveniently checked nearly anytime, anywhere.

\* Available in Cruise Mode (repeatedly moves to designated locations). Must be additionally mapped when store interior changes.

\*\* Voice announcement during movement can be changed. (Future update will allow voice announcement upon arrival to be changed.)

Providing perfect service,  
anytime, anywhere

**LG CLOi** ServeBot



### Restaurants / Franchises

---

Enhance serving efficiency  
and reduce the physical burden  
on employees with  
swift multi-point delivery



### Hotels / Resorts / Residences

---

Improve customer satisfaction  
and service with safe and convenient  
contactless serving





### Communal Spaces

Widely applicable in shared kitchens and communal spaces in various facilities, improving serving efficiency and giving the space more character.



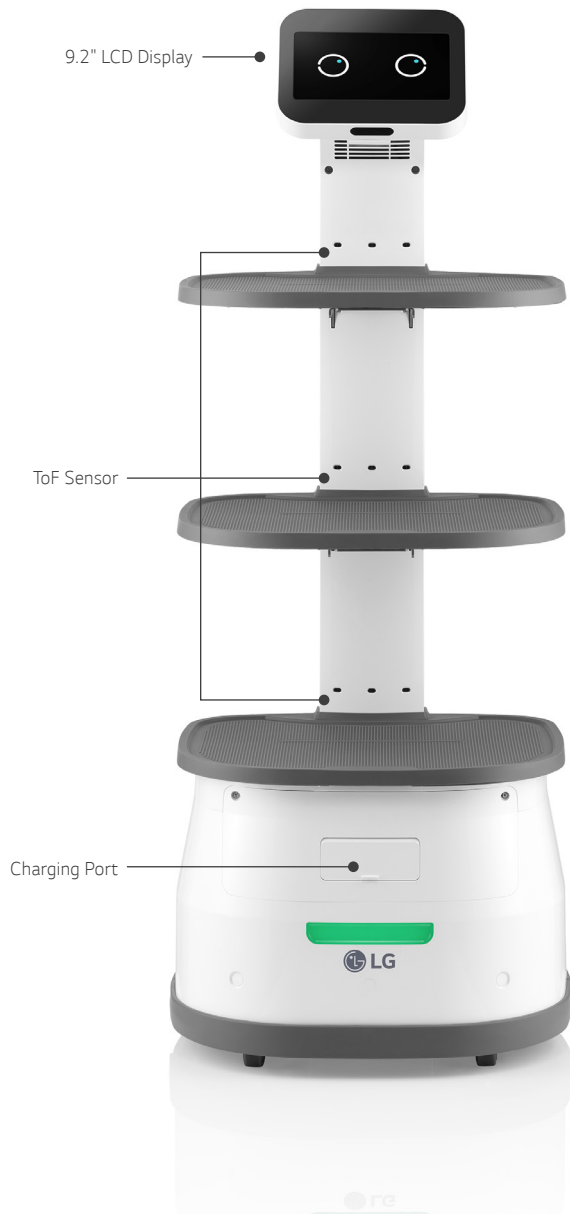
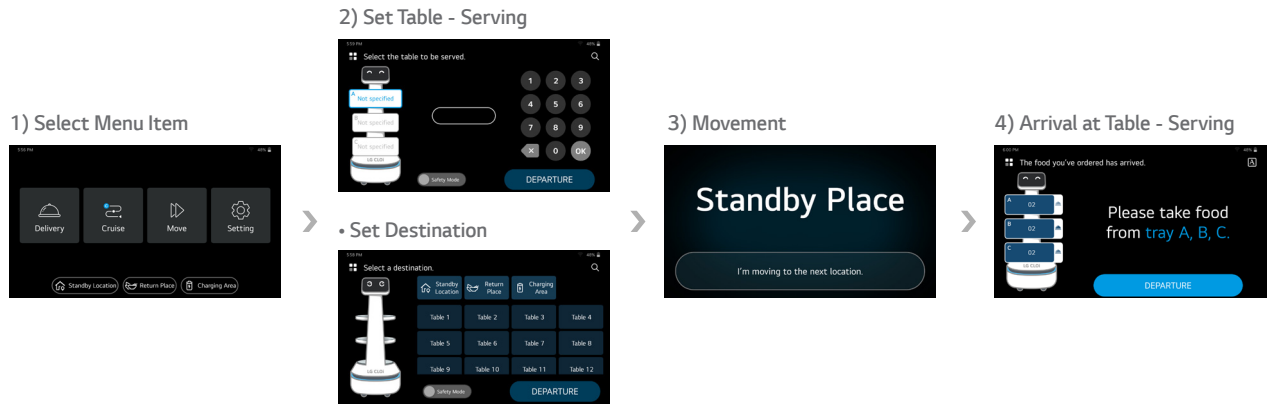



## The Swift and Reliable Serving Specialist

- UL 3300 certified for safe robot operation in complex commercial environments such as restaurants, retail stores and hotels.
- Autonomous obstacle recognition and avoidance
- Max load: 66 lbs (22 lbs per shelf, 3 total)
- Cruise mode support
  - Repeatedly moves to designated locations: can be set directly by user.
- Convenient screen operation

Requires advance mapping of table layout for service area.

|                    |                                       |  |
|--------------------|---------------------------------------|--|
| Specification      | Dimensions (W x H x D)                | 20.1 x 51.2 x 20.1 in                          |
|                    | Weight                                | 132.3 lbs                                      |
|                    | Load capacity                         | 66.14 lbs (each drawer holds up to 22.05 lbs)  |
|                    | Number of Shelves                     | 3  |
|                    | Shelf size (W x L)                    | 19.7 x 15.75 in                                |
|                    | Sensor                                | LiDAR / 3D Camera / ToF / Bumper               |
|                    | Display                               | 9.2" Touch LCD Display                         |
|                    | Status LED (action / status alert)    | RED / BLUE / GREEN                             |
| Battery            | Connectivity                          | Wi-Fi  |
|                    | Capacity                              | 25,000mAH                                      |
|                    | Charging time                         | 5 hours  |
|                    | Continuous operating time             | 11 hours                                       |
|                    | Battery certification                 | UL2271   |
| Language           | Charging type                         | Manual   |
|                    | Voice / Display                       | Korean / English / Spanish / French / Japanese |
|                    | Voice Content                         | Driving, Arrival notification (call / text)    |
| Autonomous Driving | Voice content phrases / music change  | Yes  |
|                    | Driving mode                          | General mode / Safe mode                       |
|                    | Obstacle recognition                  | Automatic obstacle recognition                 |
|                    | Obstacle avoidance                    | Real-time route planning & driving             |
|                    | Speed (max.)                          | 1.0m/s (adjustable)                            |
|                    | Drive width (min.)                    | 27.6 in  |
|                    | Surface compability                   | Marble / Tile / Cement                         |
| Certification      | Cruise driving path setting           | User-configurable                              |
|                    | Safety / Electromagnetic wave         | KC   |
| Others             | Safe Robot Operation                  | UL 3300  |
|                    | Remote calling app.                   | Yes  |
|                    | Automatic detection of food unloading | Yes  |



[lgsolutions.com](https://lgsolutions.com)

Copyright 2022 ©LG Electronics USA, Inc., 2000 Millbrook Drive Lincolnshire, IL 60069, USA. All rights reserved. LG and the LG logo are registered trademarks of LG Corp. All other products and brand names are trademarks or registered trademarks of their respective companies. Designs, features, and specifications are subject to change without notice. Prices, promotions, and availability may vary by dealer. All screen images are simulated.  
CAT\_CLOi\_ServeBot\_012215\_LR